

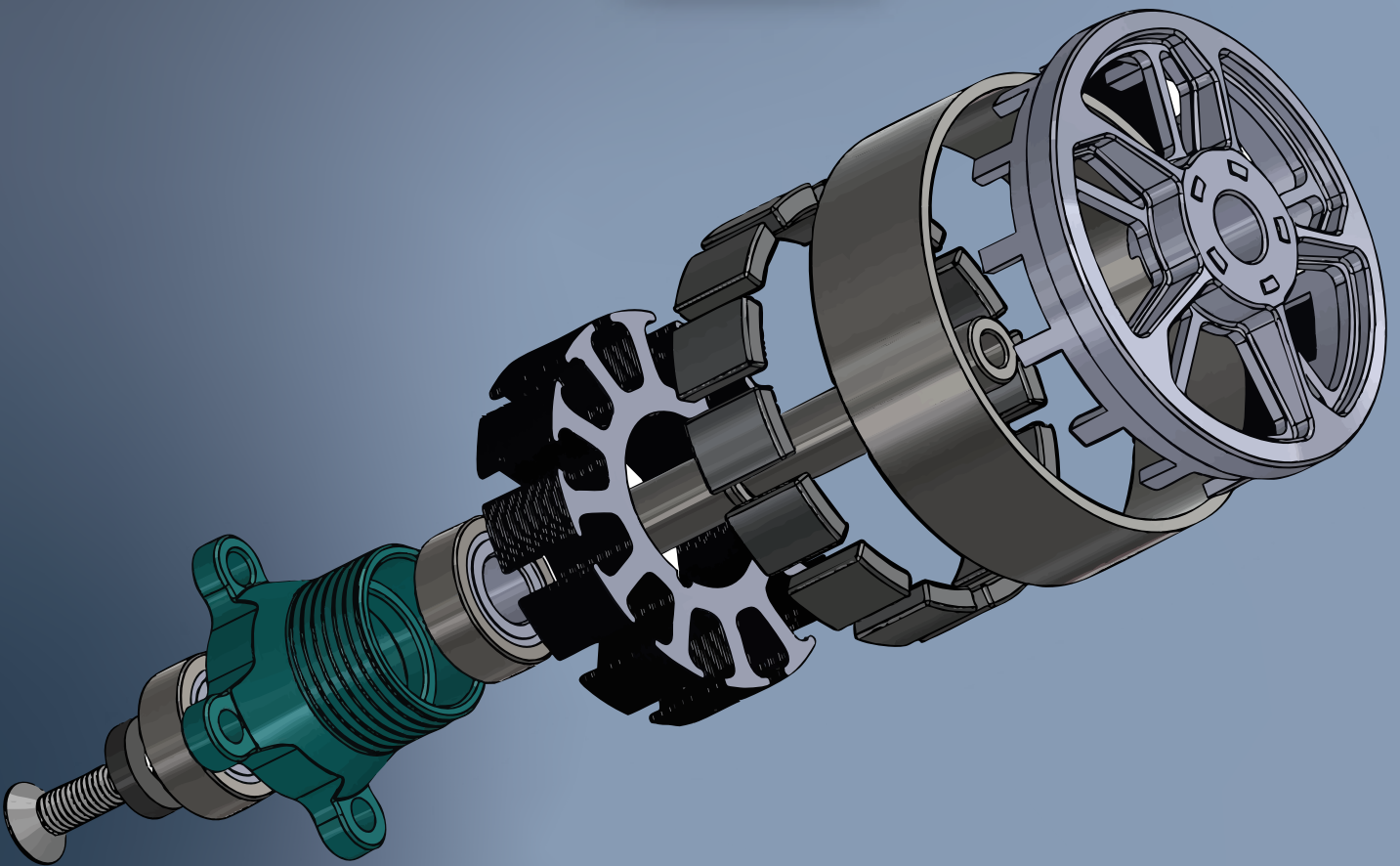

EMPOWERING FUTURE

Reliable, Efficient & Advanced Motor Solutions
for the Next Generation of Drones

2807 BRUSHLESS OUTRUNNER MOTOR 1300KV



FPV Motor

Mecwin FPV Drone Motors deliver high RPM, strong torque, and low power consumption for smooth, stable, and fast flights. Built with lightweight aluminum alloy, precision bearings, and advanced cooling, they ensure durability, efficiency, and reliable performance—perfect for racing and freestyle pilots.

Key Features :

- High RPM & Fast Response – Designed for quick throttle changes and stable flight.
- Lightweight Design – Compact and optimized for drones to reduce overall weight.
- Durable Build – Uses high-quality materials like aluminum alloy and strong magnets for long life.
- Efficient Cooling – Open design or special ventilation to prevent overheating.
- Smooth Performance – Precision bearings for reduced vibration and stable footage.
- Energy Efficient – Optimized for longer flight times with less power consumption.



Outline Drawing :

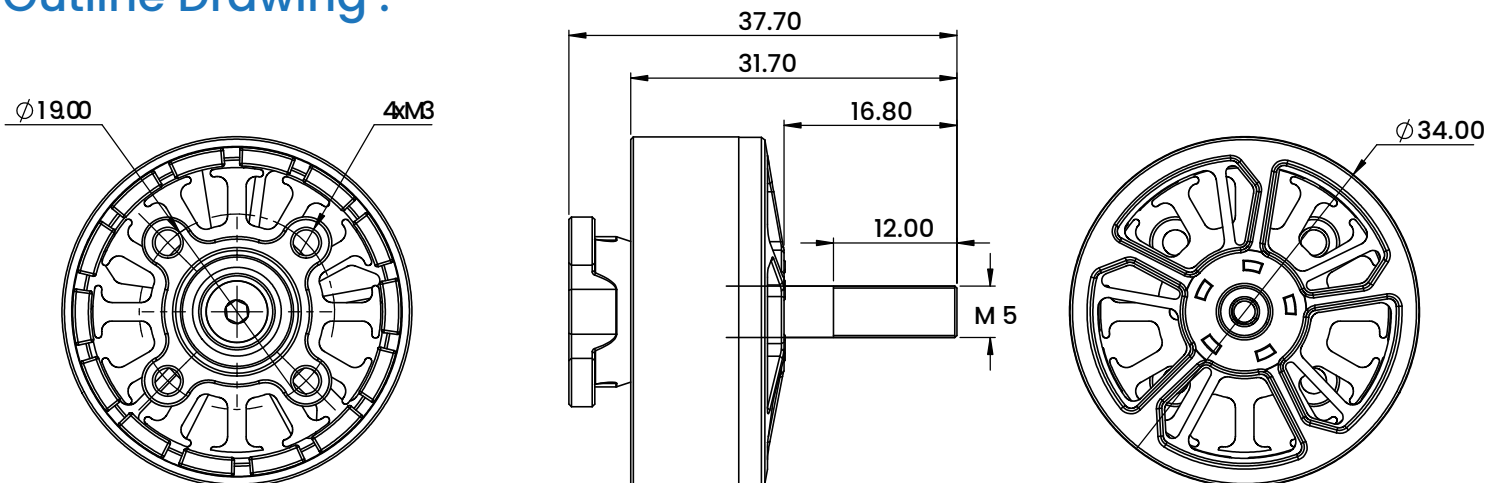

Specifications :

MECWIN 2807 - 1300KV Specifications			
Brand	Mecwin	ESC	6S 50A
Model	2807	Insulation resistance (M Ω)	≥ 0.5
KV	1300KV	Stator material	0.2mm silicon steel
Numbers of cells (lipo)	6S	Propeller	HQ 7X3.5X3
Configuration	12N14P	Prop adapter shaft thread	M5
AWG	18AWG	Bearing	SKF/NSK/NMB
Internal resistance (m Ω)	80	Weight including cable	48g Including Cable
Max power (W)	1071.2	Bell cap material	Al 7075
Max current (A)	45.2	Bell casing material	Al 7075
Magnet type	N52H	Shaft material	Titanium alloy / SUS420
Idle Current (No load current @10 V) (A)	1.02A/10V	Bolt pattern	M3 (19X19mm)

2807 -1300KV-6S-HQ-7X3.5X3 Load Test Data :

Propeller (in)	Throttle %	Volts (V)	Current (A)	RPM	Thrust (gf)	Watts (W)	Thrust Efficiency (G/W)	Copper Wire Temperature (°C)
HQ 7X3.5X3	30	24	2.7	7200	650	64.8	10.03	The inside of motor copper wire (75°C)
	40	24	7.7	9200	1200	184.8	6.49	
	50	24	12.2	11200	1850	292.8	6.32	
	60	24	16.7	12800	2400	400.8	5.99	
	70	23.9	25.2	14500	2900	602.3	4.82	Ambient temperature is (25°C)
	80	23.9	33.2	16200	3300	793.5	4.16	
	90	23.8	40.2	17800	3600	956.8	3.76	
	100	23.7	45.2	19200	3800	1071	3.55	

NOTE : Copper wire temperature inside the motor after 2 minutes of running at full load (100% throttle)

Applications :

